



Zylinderschaft/queue zyl./zyl. shank
DIN 1835A, DIN 6535HA



Weldon-Fläche/plat-Weldon/Weldon-clamping
DIN 1835B



Weldon-Fläche/plat-Weldon/Weldon-clamping
DIN1835HB

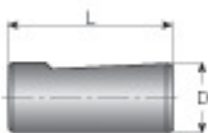

Wistle-Notch-Fläche/W.-N-plat/W.-N.- clamping
DIN 1835HE



Wistle-Notch-Fläche/W.-N-plat/W.-N.- clamping
DIN 1835HE



DIN228AK

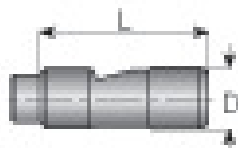

zentrale Klemmung/plat de serrage central/ central clamping surface
15°

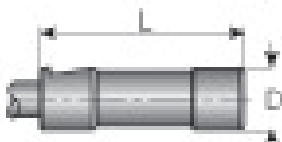

Frontale Klemmfläche/plat de serrage frontal/Frontal clamping surface
15°

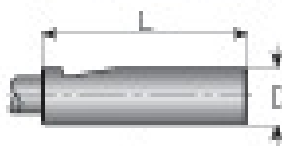

Frontale Klemmfläche/plat de serrage frontal/frontal clamping surface
15°

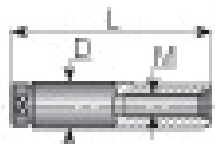

VDI Ausführung/ VDI design/ éxecution VDI

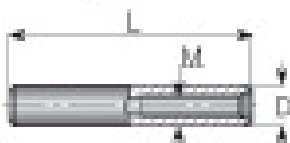

Zylinderschaft mit Anzugsgewinde/
Queue cylind. avec filetage/cylind. shank with thread



DIN228BK

Schaft DIN 6535

DIN 6535 Form HA

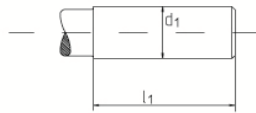

d_1 h6	l_1^{+2}
2	28
3	
4	
5	
6	36
8	
10	40
12	45
14	
16	48
18	
20	50
25	56
32	60

DIN 6535 Form HB

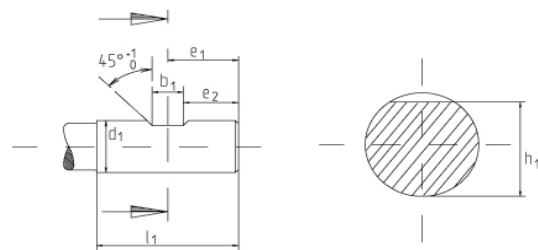

d_1 h6	l_1^{+2}	$b_1^{+0,05}$	e_{1-1}	h_1 h11	l_2^{+1}	
6	36	4,2	18	5,1	-	
8		5,5		6,9		
10	40	7	20	8,5		
12	45	8	22,5	10,4		
14				12,7		
16	48	10	24	14,2		
18				16,2		
20	50	11	25	18,2		
25	56	12	32	23		17
32	60	14	36	30		19

Zwei Mitnahmeflächen für $\varnothing 25$ und $\varnothing 32$

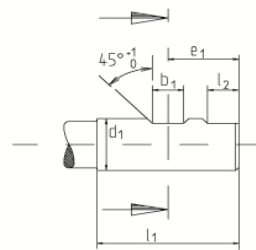

DIN 6535 Form HE

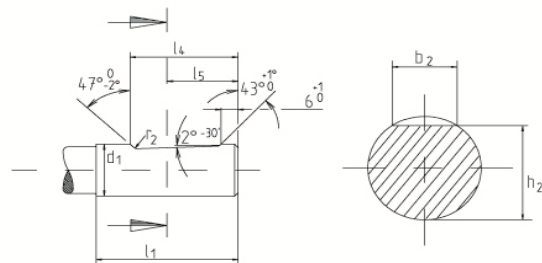

d_1 h6	l_1^{+2}	b_2	(b_3)	h_2 h11	(h_3)	l_{4-1}	l_5	$r_{2 \text{ min}}$
6	36	4,3	-	5,1	-	25	18	1,2
8		5,5		6,9				
10	40	7,1	-	8,5	-	28	20	
12	45	8,2		10,4				
14		8,1	12,7	33	22,5			
16	48	10,1	14,2					
18		10,8	16,2	36	24			
20	50	11,4	18,2			38	25	
25	56	13,6	9,3	23	24,1			44
32	60	15,5	9,9	30	31,2	48	35	

Für $\varnothing 25$ und $\varnothing 32$

